



"WHHR" - whole house heat recovery



- For wall or loft installation or above cooker canopy
- 2 models
- Exchanges stale air for fresh with no more than 20% heat loss
- Continuous running at low speed
- Optional summer vent switch
- BRE Digest 398 Compliant
- BEAB Approved
- Exceeds Building Regulations requirements (including new Document F)

GENERAL

- for wall or loft insulation
- speed controller incorporated within casing (if installed in loft remote controller must be used)
- optional cooker canopy can be used when siting above cooker - canopy incorporates filter, light and boost control
- choice of 5 low speed settings on installation for precise ventilation control
- runs continuously at low speed
- can be switched to higher speed for pre-determined length of time
- up to 80% of heat recovered
- optional summer ventilation switch prevents heat recovery but maintains ventilation during summer months
- controls condensation
- whisper quiet operation

SPECIFICATION

- robust aluminium plate heat exchanger for long life and high efficiency rating - easily removed for maintenance
- casing from white aludip steel

COMPLY WITH

- EN60335-2-80
- EC Low Voltage Directive 73/23-93/68
- EC Directive EMC89/336
- CE marked
- BEAB Approved

TYPICAL SPECIFICATION

Supply and install a WHHR250 Whole House Heat Recovery Unit for wall installation above a cooker hood canopy (WHHRCC) as supplied by Vectaire Ltd, Lincoln Road, Cressex Business Park, High Wycombe, Bucks, HP12 3RH.

This unit should have a choice of five low speed settings so that it can be precisely adjusted on installation to suit the size of dwelling. It should then run continuously at that low speed, but have the facility of being switched to a higher speed for a pre-determined length of time when necessary.

It should save up to 80% of heat recovered and be capable of being fitted with an optional summer switch to prevent heat recovery whilst maintaining proper ventilation levels. The canopy should incorporate a filter to remove moisture and dirt from incoming air.

The unit should be BEAB Approved and Marked, CE marked be BRE Digest 398 Compliant.

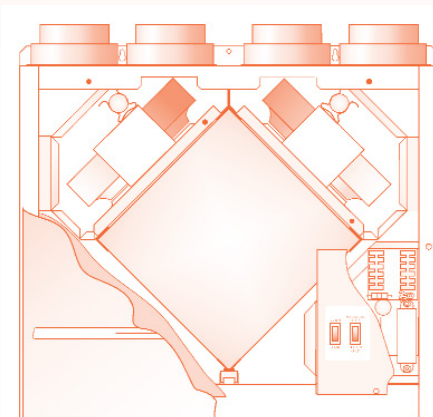
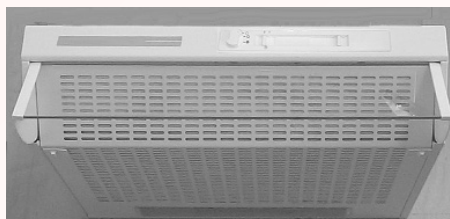

RANGE

- **WHHR150**
for dwellings up to 350m³
- **WHHR250**
for dwellings up to 460m³



TECHNICAL CHARACTERISTICS

WIRING DIAGRAMS

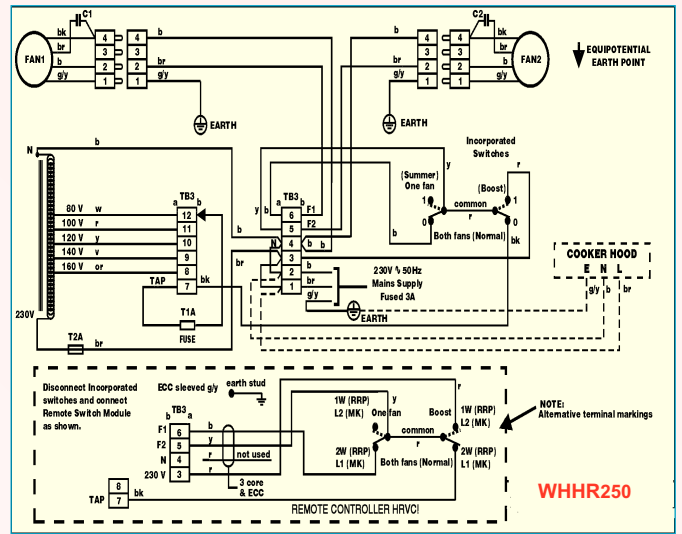
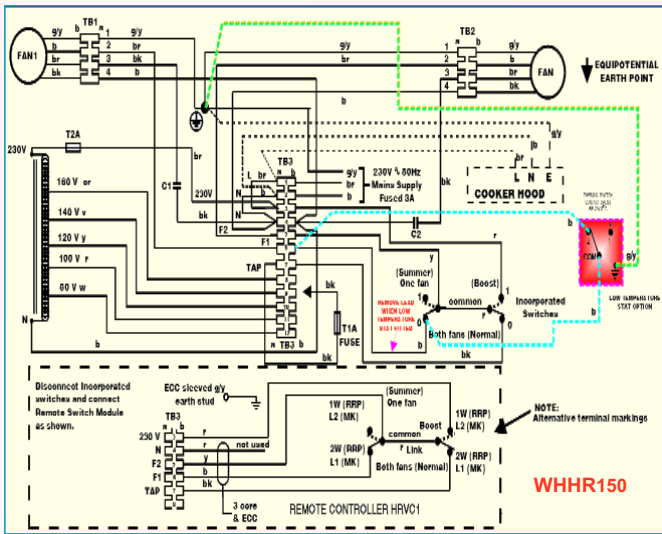

DIMENSIONS

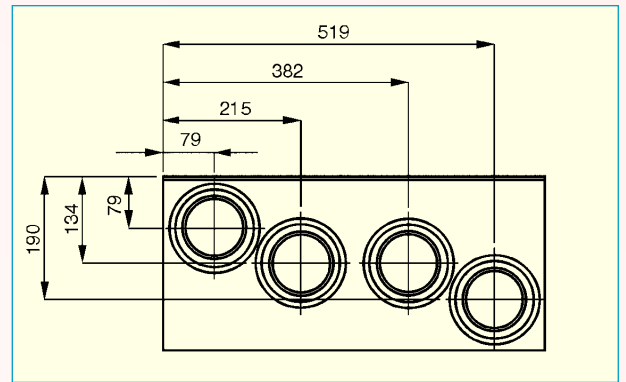
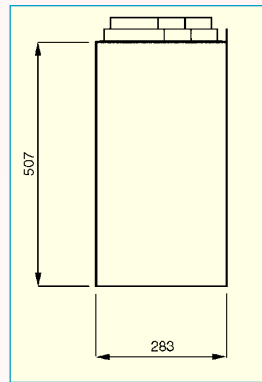
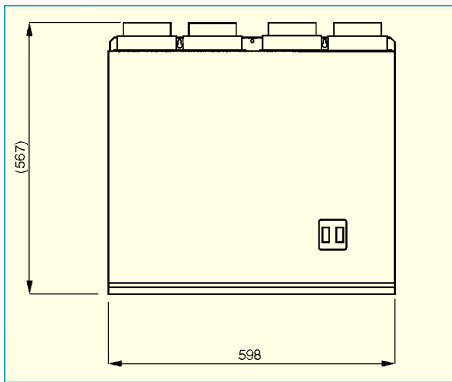

PRESSURE CURVE

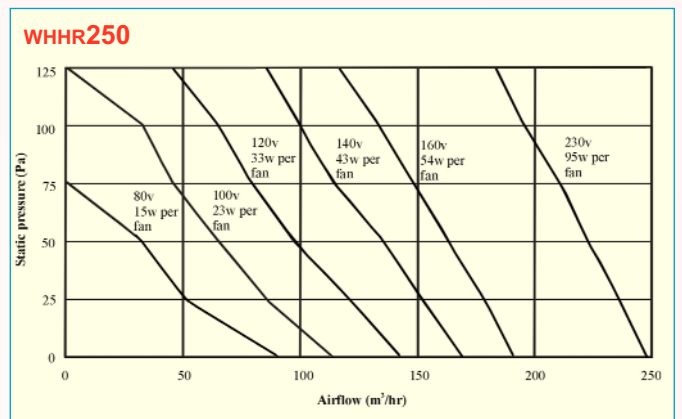
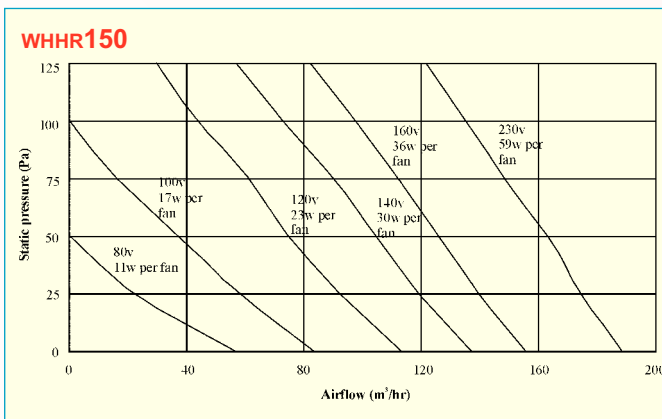

FULL RANGE OF ACCESSORIES AVAILABLE INCLUDING FLEXIBLE AND FLAT DUCTING

Vectaire Ltd

Lincoln Road, Cressex Business Park
High Wycombe, Buckinghamshire, HP12 3RH

Tel: +44(0)1494 522333
Fax: +44(0)1494 522337

Email: sales@vectaire.co.uk
Web: www.vectaire.co.uk